

BUILDING GROSS
SF 60,750 GSF

SYLVANSPORT
30,375 GSF
5,931 OFFICE

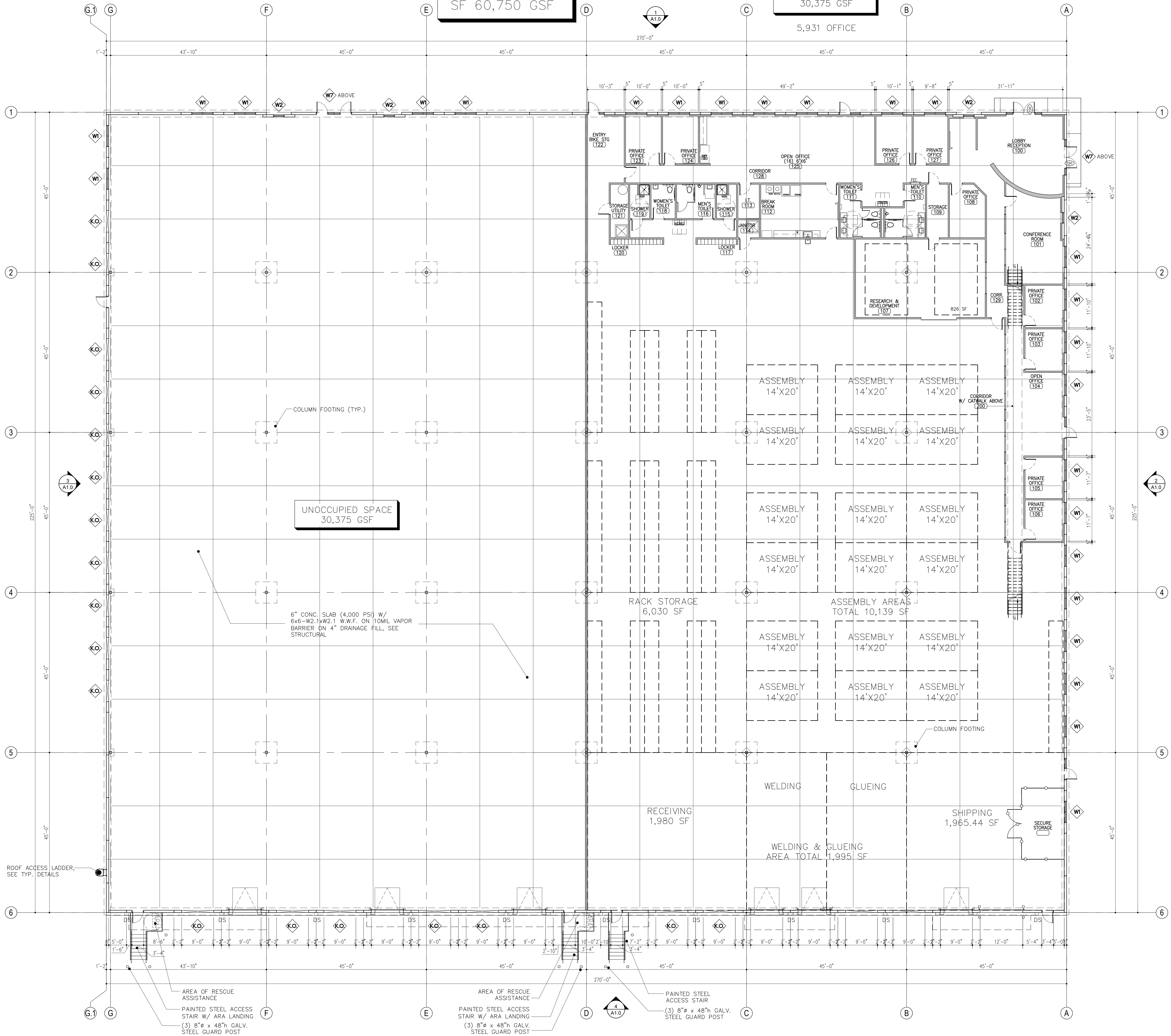

UNOCCUPIED SPACE
30,375 GSF

8" CONC. SLAB (4,000 PSI) W/
6x6-W2.1xW2.1 W.W.F. ON 10MIL VAPOR
BARRIER ON 4" DRAINAGE FILL, SEE
STRUCTURAL

RACK STORAGE
6,030 SF

ASSEMBLY AREAS
TOTAL 10,139 SF

RECEIVING
1,980 SF

SHIPPING
1,965.44 SF

WELDING & GLUEING
AREA TOTAL 1,995 SF

AREA OF RESCUE ASSISTANCE
PAINTED STEEL ACCESS STAIR W/ ARA LANDING
(3) 8" x 48" GALV. STEEL GUARD POST

AREA OF RESCUE ASSISTANCE
PAINTED STEEL ACCESS STAIR
(3) 8" x 48" GALV. STEEL GUARD POST

PAINTED STEEL ACCESS STAIR
(3) 8" x 48" GALV. STEEL GUARD POST

1 OVERALL FLOOR PLAN
A1.0 SCALE: 3/32" = 1'-0"

General Notes:

1. ALL THINGS WHICH IN THE OPINION OF THE CONTRACTOR APPEAR TO BE DEFICIENCIES, OMISSIONS, CONTRADICTIONS OR AMBIGUITIES IN THE PLANS OR SPECIFICATIONS SHALL BE BROUGHT TO THE ATTENTION OF THE ARCHITECT. CORRECTIONS OR WRITTEN INTERPRETATIONS SHALL BE ISSUED BEFORE CONSTRUCTION OF THE AFFECTED WORK MAY PROCEED.
2. CONTRACTOR IS RESPONSIBLE FOR COORDINATING ALL DIMENSIONS SHOWN ON THE CONTRACT DOCUMENTS. INCONSISTENCIES ON THE CONSTRUCTION DRAWINGS OR BETWEEN THE CONSTRUCTION DRAWINGS AND ANY OTHER CONTRACT, SHOP, FABRICATION OR OTHER DRAWINGS OR INFORMATION SHALL BE BROUGHT TO THE ATTENTION OF THE ARCHITECT PRIOR TO PROCEEDING WITH AFFECTED WORK.
3. DIMENSIONS ARE TO FACE OF MATERIAL OR COLUMN CENTERLINE UNLESS OTHERWISE NOTED.
4. "ALIGN" SHALL MEAN TO ACCURATELY LOCATE FINISH FACES IN THE SAME PLANE.
5. "TYPICAL" OR "TYP" SHALL MEAN THAT THE CONDITION IS REPRESENTATIVE FOR SIMILAR CONDITIONS THROUGHOUT, UNLESS OTHERWISE NOTED. DETAILS ARE USUALLY KEYED AND NOTED "TYP" ONLY ONCE, WHEN THEY FIRST OCCUR.
6. "SIMILAR" OR "SIM" MEANS COMPARABLE CHARACTERISTICS FOR THE CONDITIONS NOTED. VERIFY DIMENSIONS AND ORIENTATION ON PLANS AND ELEVATIONS.
7. "EQUAL" OR "EQ" SHALL MEAN PRODUCTS OF EQUAL FUNCTION AND QUALITY TO THOSE INDICATED.
8. "AS REQUIRED" SHALL MEAN AS NECESSARY FOR PROPER FUNCTION, UTILITY AND/OR FINISHED APPEARANCE TO PERFORM THE INTENDED PURPOSE, AND SHALL INCLUDE ALL LABOR, PARTS, RELATED COMPONENTS, AND/OR ACCESSORIES, NEEDED FOR A COMPLETE INSTALLATION.
9. "PROVIDE" SHALL ALWAYS MEAN FURNISH AND INSTALL, CONNECT OR SECURE AS REQUIRED.
10. ALL WORK NOTED "BY OTHERS" OR "MIC" SHALL BE PROVIDED BY OWNER OR UNDER SEPARATE CONTRACT.
11. "UNO" SHALL MEAN "UNLESS NOTED OTHERWISE".
12. "TBD" SHALL MEAN "TO BE DETERMINED".
13. REFER TO PLUMBING, MECHANICAL, AND ELECTRICAL DRAWINGS FOR RELATED WORK BY THOSE TRADES.
14. ALL MATERIALS AND EQUIPMENT SHALL BE INSTALLED IN STRICT ACCORDANCE WITH MANUFACTURER'S WRITTEN INSTRUCTIONS AND TRADE ASSOCIATION'S ACCEPTED STANDARDS.
15. ALL MATERIALS TO BE NEW U.N.O.
16. REFER TO STRUCTURAL DRAWINGS FOR SPECIFICATIONS AND DETAILS RELATIVE TO CONCRETE FLOOR SLABS, CONCRETE WALL PANELS, STEEL FRAMING, AND ROOF DECK.
17. PROVIDE WHITE FACTORY PRIMED METAL ROOF DECK.
18. STRUCTURAL STEEL TO BE FACTORY PAINTED PRIMER GRAY, U.N.O.
19. ALL EXTERIOR GLAZING SHALL BE TINTED, INSULATED, LOW-E GLASS IN CLEAR ANODIZED ALUMINUM STOREFRONT FRAMES. GLAZING TO BE TEMPERED WHERE REQUIRED BY CODE. COLOR T.B.D.
20. ALL EXTERIOR METAL TRIM, CANOPIES, LOUVERS, GUTTERS AND DOWNSPOUTS, SHALL BE MADE OF FIRE-FINISHED ALUMINUM OR GALVANIZED STEEL WITH FLUOROPOLYMER FINISH, U.N.O.
21. EXTERIOR OF CONCRETE PANELS TO BE PAINTED WITH TEXTURED ACRYLIC COATING. COLOR TBD (SEE COLOR DIAGRAM). SEE FINISH SCHEDULE FOR INTERIOR FINISH.
22. SEAL ALL PANEL JOINTS AT INT. AND EXT. FACE. SEALANT TO MATCH PANEL COLORS.
23. PROVIDE OPENINGS IN CONCRETE TILT WALL PANELS AS REQUIRED FOR PLUMBING, MECHANICAL, ELECTRICAL & FIRE PROTECTION SYSTEMS.
24. PROVIDE OSHA APPROVED ROOF ACCESS LADDER WHERE INDICATED.

Wall Type Legend:

- NEW INTERIOR WALL CONSTRUCTION; 3/4" WTL STUDS AT 16" o.c. MAX. WITH 3/4" PAINTED G.W.B. ON EACH SIDE TO DECK, PROVIDE 3" 1/2" SOUND ATTENUATION BATS. SEE WALL TYPE SECTIONS FOR CLARIFICATION AND NOTES.
- NEW INTERIOR WALL CONSTRUCTION; 3/4" WTL STUDS AT 16" o.c. MAX. WITH 3/4" PAINTED G.W.B. ON EACH SIDE TO 6" ABOVE FINISHED CEILING, PROVIDE 3" 1/2" SOUND ATTENUATION BATS. SEE REFLECTED CEILING PLAN FOR CEILING HEIGHTS, BRACE & BRIDGE AS REQUIRED. SEE WALL TYPE SECTIONS FOR CLARIFICATION AND NOTES.

Symbols Legend:

- ELEVATION
- SECTION
- DETAIL
- WINDOW TAG
- DOOR TAG
- WALL TYPE
- WAREHOUSE ROOM TAG
- FINISHED FLOOR ELEV. SPOT ELEV.

Key Plan:

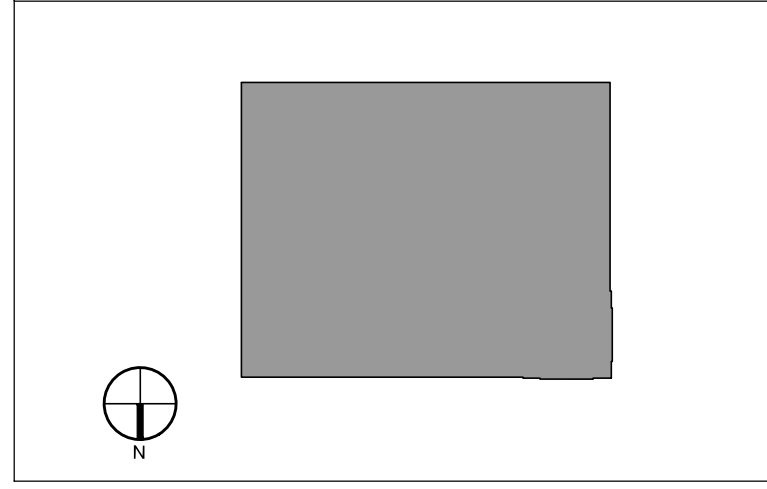

330 w. 10th Street
Charlotte, NC 28202
704.333.9952 phone
704.333.9962 fax
www.winnarch.com

WIN ARCHITECTS
ARCHITECTS
Designs for a changing world

FOR REVIEW ONLY
NOT FOR CONSTRUCTION



New Shell and Upfit for:
TRANSYLVANIA ECONOMIC Alliance
Brevard, North Carolina 28712

Project:
Project No. 16207
Date Issued: June 30, 2017
Revisions:

- 1.
- 2.
- 3.
- 4.
- 5.
- 6.

Overall Floor Plan

Sheet Title
Design Development Phase

A1.0

WIN ARCHITECTS hereby reserves their common law copyright and other property rights in these plans, ideas and designs. These plans, ideas and designs are not to be reproduced, changed or copied in any form or manner whatsoever, nor are they to be assigned to any third party without first obtaining the express written permission from WIN ARCHITECTS. Written dimensions on these drawings shall have precedence over scaled dimensions. Contractors shall verify and be responsible for all dimensions and conditions on the job and WIN ARCHITECTS must be notified in writing of any variations from the dimensions, conditions and specifications on these drawings.